

## RANGE 1.7500 – LATCH AND DEADBOLT – DOUBLE CYLINDER

- Suitable for wooden or metal doors. Viro Hologram against possible imitations.
- Left or right handed rim door locks, with reversible latch.
- **Case:** one-piece, painted steel.
- **Rear cover:** galvanized and passivated steel.
- **Supplied with standard striker in painted steel.**
- **Latch and deadbolt:** solid brass.
- **Reversible latch** with dogging device.
- **Supplied with Viro 5 pin double cylinder**, loose Item 712 or fixed Item 714. Mushroom brass counterpins, pick-resistant.
- **Supplied with 3 nickel plated brass keys** Item 015 Viro profile.  
Key opening both from outside or inside.
- **All special executions are possible for the cylinder.**



DOUBLE THROW VERSION ITEM No.	Backset mm E	Case Dimensions mm A x B	Throw projection mm C	Keys Item No.	Unit Weight (without cylinder) g
1.7501	40	80 x 92	24	015	655
1.7502	50	100 x 92	24	015	710
1.7503	60	120 x 92	24	015	770
1.7504	70	140 x 92	24	015	835

TRIPLE THROW VERSION ITEM No.	Backset mm E	Case Dimensions mm A x B	Throw projection mm C	Keys Item No.	Unit Weight (without cylinder) g
1.7512	50	100 x 92	35	015	755
1.7513	60	120 x 92	35	015	815
1.7514	70	140 x 92	35	015	880

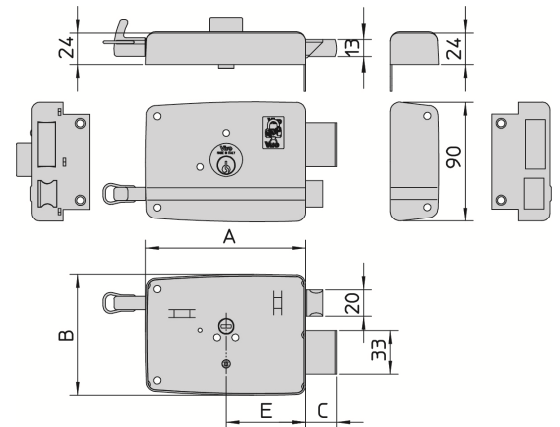

## RANGE 1.7600 – LATCH AND DEADBOLT – INSIDE KNOB OUTSIDE CYLINDER

- Suitable for wooden or metal doors. Viro Hologram against possible imitations.
- Left or right handed rim door locks, with reversible latch.
- **Case:** one-piece, painted steel.
- **Rear cover:** galvanized and passivated steel.
- **Supplied with standard striker in painted steel.**
- **Latch and deadbolt:** solid brass.
- **Reversible latch** with dogging device.
- **Supplied with Viro 5 pin cylinder**, loose Item 712 or fixed Item 714.
- **Ergonomic brass-plated internal knob.**
- **Supplied with 3 nickel plated brass keys** Item 015 Viro profile.
- **All special executions are possible for the cylinder.**



DOUBLE THROW VERSION ITEM No.	Backset mm A	Case Dimensions mm A x B	Throw projection mm C	Keys Item No.	Unit Weight (without cylinder) g
1.7601	40	80 x 92	24	015	645
1.7602	50	100 x 92	24	015	700
1.7603	60	120 x 92	24	015	760
1.7604	70	140 x 92	24	015	825

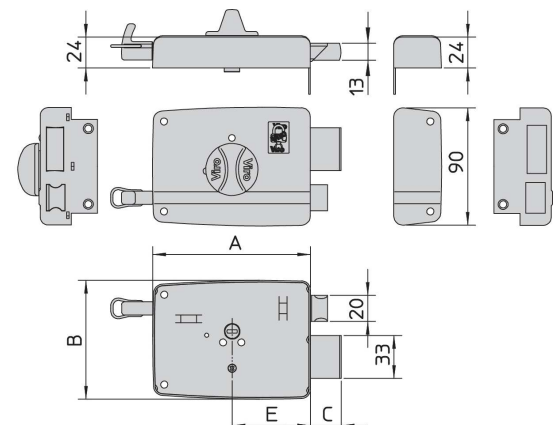

Add the required cylinder code (.712 or .714) and the version (.1=right .2=left) after the item code.  
 E.g. 1.7503.712.1 = Rim door lock, backset 60 mm with loose external cylinder, right version.  
 E.g. 1.7603.714.2 = Rim door lock with knob, backset 60 mm with fixed external cylinder, left version.

## RANGE 1.7520 – LATCH AND DEADBOLT – WITH HANDLE HOLE

- **Perfectly interchangeable** with the most common lock models with handle holes on the market.
- **Can be fitted in wooden or metal doors** .
- Viro **Hologram** on the case to distinguish it from possible imitations.
- **Galvanized and passivated steel cover.**
- **Case and painted steel stiker or galvanized steel.**
- **Reversible latch:** solid brass, key or handle-operated from the outside, handle-operated only from the inside.
- **Deadbolt:** brass, with triple throw, key operated from the inside and the outside.
- **Viro 5 pin, fixed, solid brass cylinder:**  
external Item 717 and Internal Item 714.  
Mushroom brass counterpins, pick-resistant.
- **Supplied with 3 nickel plated brass keys** Item 015 Viro profile.
- **Supplied with:** brass oval escutcheon, painted steel stiker or galvanized steel, washer and fixing screws.
- All special executions are possible for the cylinder.



	ITEM No.	Backset mm E	Case Dimensions mm A x B	Throw Projection mm C	Keys Item No.	Unit Weight g
<b>Right</b>	<b>1.7523.0714.1.000</b>	<b>60</b>	140 x 92	35	015	1070
<b>Left</b>	<b>1.7523.0714.2.000</b>	<b>60</b>	140 x 92	35	015	1070

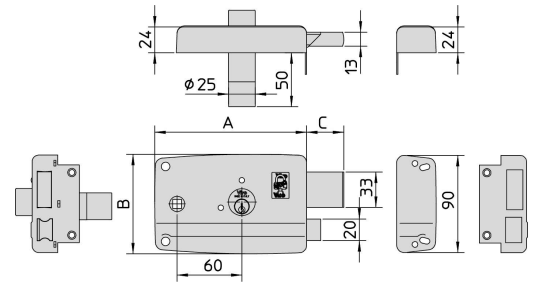

- **Galvanized steel cover, 1,5 mm thick.**
- **Case and striker: 1,2 mm thick galvanized steel.**



	ITEM No.	Backset mm. E	Case Dimensions mm. A x B	Throw Projection mm. C	Keys Item No.	Unit Weight g
<b>Right</b>	<b>1.7523.0714.1.217</b>	<b>60</b>	140 x 92	35	015	1040
<b>Left</b>	<b>1.7523.0714.2.217</b>	<b>60</b>	140 x 92	35	015	1040

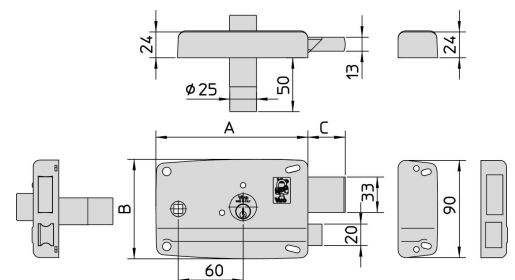

58030300205015 - 07/2011