

## TOTEM

- **One-piece cylindrical body**, case-hardened and tempered steel. "Niploy Process" corrosion-resistant nickel plating for maximum corrosion resistance.
- **Cylinder:**
  - ✓ partially removable, in order to open the external chain housing (opposite to the key side);
  - ✓ fully and simply removable, for the application of a new chain or for the replacement of the lock-bolt;
  - ✓ with padlock locked, key plug is in anti-pull position and completely body fitted; key hub protected by a grey rubber dust-proof cap.
- **Lock-bolt** easily replaceable with completely open cylinder.
- **Mechanism** allows about 5.500 different combinations:
  - ✓ brass pins and counterpins;
  - ✓ inox stainless steel pin springs.
- **Keys:** supplied with 2 nickel-plated brass keys; numbering on request to ensure easy product tracking Viro Top Security profile.
- **All special executions are possible.**

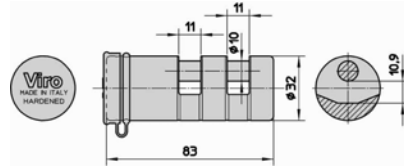

ITEM No.	Body dimensions mm	Horizontal and vertical clearance mm C - F	Lock-bolt diameter mm D	Keys Item No.	Unit weight g	Pcs. per pack No.
4150	83 x 32	10,9 x 11	10	1.033	420	8



## TOTEM WITH CHAIN

- **Chain: Semi-squared** (to counter shears that generally have blades for cutting rounded profiles) **case-hardened, tempered, drawn and galvanized special steel** (nickel-chrome-molybdenum). The chain has a 10 mm wire diameter and is protected by a blue fabric scratch-proof cover that minimizes its bulk.
- Supplied with a useful nylon textile carrying bag.
- **Packaging:** single visual pack:item inside the personalized carrying bag with card.



ITEM No.	Chain wire diameter mm D	Chain length mm	Unit weight g	Keys Item No.	Pcs. per pack No.
4150.90	10	90	2455	1.033	1
4150.120	10	120	3110	1.033	1
4150.150	10	150	3720	1.033	1

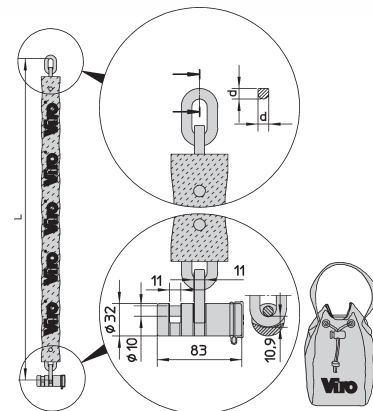

58030270205015 - 05/2012

## MORSO and SUPERMORSO

- **Body:** brass, coated in case-hardened, tempered, copper and nickel plated steel armour (for item 4231.500), in case hardened, tempered, galvanized and powder-painted black steel armour (for item 4239.500). Ideal to be combined with chains as it is designed to be longitudinal to the chain, making it longer; mainly indicated for motorcycles and scooters, as it is easy to carry.
- **Lock-bolt:** rotating steel lock-bolt case-hardened, tempered, cooper and nickel plated steel for high resistance to attack; pull resistant inserted head.
- It is possible to fix the chain to the padlock with a inox stainless steel pin.
- **Keys:** supplied with 2 brass nickel plated keys.
- All special executions are possible.



ITEM 4231.500

ITEM 4239.500

ITEM No.	Body dimensions mm A x B x E	Horizontal and vertical clearance mm F x C	Lock-bolt diameter mm D	Keys Item No.	Net weight per pcs. g	Pcs. per pack No.
4231.500	64 x 33 x 17	10 x 8,2	7,5	011	200	50
4239.500	74 x 40 x 24	11 x 9	9,5	033	350	50

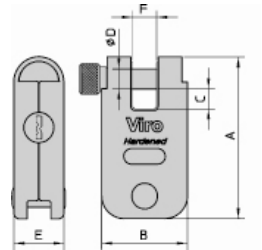

## MORSO WITH CHAIN WIRE DIAMETER mm 5,5

- **Locking device** with 4 pin brass plug, pull resistant.
- **Semi-squared special steel chain** with 5,5 mm wire diameter. It is fixed to the Morso padlock with a riveted inox stainless steel pin and protected by a yellow plastic cover anti-scratch.
- **Keys:** supplied with 2 Viro profile nickel-plated brass keys.
- Single visual pack.

ITEM No.	Chain wire diameter mm	Chain length mm	Unit weight g	Keys Item No.	Pcs. per pack No.
1.4232	5,5	60	710	011	1
1.4234	5,5	90	950	011	1
1.4236	5,5	120	1190	011	1
1.4238	5,5	150	1410	011	1

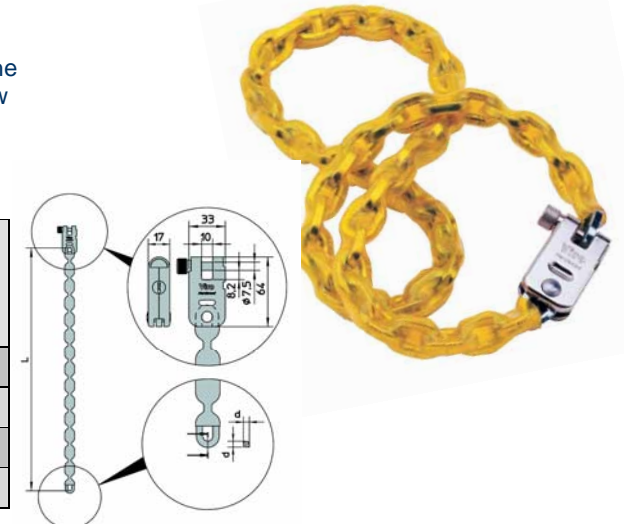

## SUPERMORSO WITH CHAIN WIRE DIAMETER mm 7

- **Locking device** with 5 pin brass plug, pull-resistant and with a case-hardened, tempered, copper and nickel plated steel, attack-resistant and drill-resistant steel plate.
- **Semi-squared special steel chain** with 7 mm wire diameter. It is fixed to the Supermorso padlock with a riveted inox stainless steel pin and protected by a scratch-proof blue textile cover that minimizes its bulk.
- **Keys:** supplied with 2 Viro Top Security profile nickel-plated brass keys.
- Single visual pack.

ITEM No.	Chain wire diameter mm	Chain length mm	Unit weight g	Keys Item No.	Pcs. per pack No.
4239.90	7	90	1710	033	1
4239.120	7	120	2165	033	1
4239.150	7	150	2655	033	1



## ARMoured PADLOCKS FOR CHAINS



### BLOCCA CATENA ITEMS 4228 e 4230

- **Fully armoured brass body**, tempered, copper, nickel, case-hardened and chrome plated steel armour.
- **Independent and rotating lock-bolts**: steel with pull-resistant programmed head breakage.
- **Mechanism**: ball type locking, key retaining and with 5 pin pull-resistant plug (and drill-resistant for item 4230).
- **Keys**: supplied with 2 Viro Top Security profile nickel plated brass keys.
- All special executions are possible.

FOR CHAINS with 5 to 8 mm wire diameter	Unit weight	Keys Item	Pcs. per pack
ITEM No.	g	No.	No.
4228	325	033	6



FOR CHAINS with 7 to 10,5 mm wire diameter	Unit weight	Keys Items	Pcs. per pack
ITEM No.	g	No.	No.
4230	415	033	6



All the "Blocca Catena" are supplied in an elegant multi-pack suitable for use as a counter display.

### BLOCCA CATENA WITH CHAIN WIRE DIAMETER mm 8

- Semi-squared case-hardened, tempered, drawn and galvanized special steel chain with 8 mm wire diameter, protected by a blue fabric scratch-proof cover that minimizes its bulk.
- Single visual pack.

ITEM No.	Chain wire diameter	Chain length	Unit weight	Keys Item
	mm	mm	g	No.
4241	8	90	1710	033
4243	8	120	2165	033
4244	8	150	2655	033



### BLOCCA CATENA WITH CHAIN WIRE DIAMETER mm 10

- Semi-squared case-hardened, tempered, drawn and galvanized, special steel chain with 10 mm wire diameter protected by a blue textile cover that minimizes its bulk.
- Supplied with a useful nylon textile carrying bag.

ITEM No.	Chain wire diameter	Chain length	Unit weight	Keys Item
	mm	mm	g	No.
4245.1	10	90	2420	033
4247.1	10	120	3105	033
4249.1	10	150	3695	033
4251.1	10	200	4810	033



## ONE-PIECE BODY STEEL PADLOCKS FOR CHAIN



### THOR AND EUROTHOR STRUCTURAL FEATURES

- **One-piece body**: case-hardened and tempered steel, "Niploy Process" corrosion-resistant nickel plating for maximum corrosion resistance.
- **Cylinder**: protected by a rotating special case-hardened and tempered thick steel plate :
  - ✓ 7 pick-resistant pins with mushroom counterpins ("Thor" item 4145) – easily replaceable and re-keyable;
  - ✓ 6 pins ("Eurothor" item 4155).
- **Rotating lock-bolt** (Ø mm 13): case-hardened and tempered steel with "Niploy Process" nickel plating; programmed breakage lock-bolt head resistant to attack.
- **Locking device**: ball type, key retaining:
  - ✓ first set of tempered inox stainless steel pins and counterpins;
  - ✓ remaining pins and counterpins in brass;
  - ✓ inox stainless steel deadbolt and pin springs;
  - ✓ inox stainless steel (AISI 316) latch.



### THOR

- **Keys**: supplied with 2 nickel plated brass keys, with Viro Top Security profile (3 with patented profile versions.).
- **Versions with patented profile keys are available** (add to the item code **.PB**).
- Versions available with patented profile keys (form trademark) which can only be duplicated by Viro (**.PB** profile) or versions which can be duplicated only by Viro Authorized Centres (**.PV** profile).

ITEM No.	Body dimensions mm A x B x E	Horizontal and vertical clearance mm C - F	Lock-bolt diameter mm D	Keys Items N.	Unit weight g	Pcs. per pack No.
4145	58 x 62 x 30	14,5 x 13,5	13	039	665	6

For versions with patented keys the item code should be followed by: **.PB** or **.PV**

### EUROTHOR

- **Keys**: supplied with 2 flat, reversible, nickel-plated brass keys in sealed envelope with ownership card.



ITEM No.	Body dimensions mm A x B x E	Horizontal and vertical clearance mm C - F	Lock-bolt diameter mm D	Keys Items N.	Unit weight g	Pcs. per pack No.
4155	58 x 62 x 30	14,5 x 13,5	13	063.A	695	6

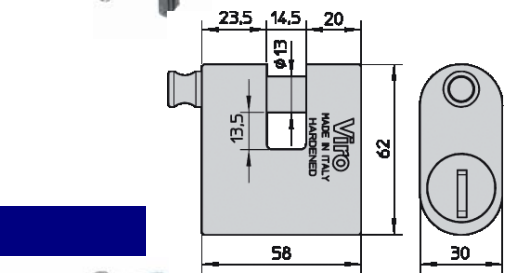

The cylinders of items 4145 and 4155 can be replaced with the 7-pin cylinder with item 039 keys.

### EUROTHOR WITH HEXAGONAL CHAIN

- **Case-hardened, tempered, drawn and galvanized special steel hexagonal chain** with 13 mm wire diameter, protected by a black textile cover that minimizes its bulk. Last ring "noose" type.
- Supplied with a useful nylon textile carrying bag.

ITEM No.	Chain wire diameter mm A x B	Chain length mm	Unit weight g	Keys Item No.	Pcs. per pack No.
4155.120	11 x 13	120	4300	063	1
4155.150	11 x 13	150	5250	063	1
4155.180	11 x 13	180	6100	063	1

